

# REFERENCE PROJECTS WET GRINDING PLANTS

## ENEL POWER Torrevaldaliga Nord, Italy Limestone wet grinding plant 2 x 28 tph (FGD)

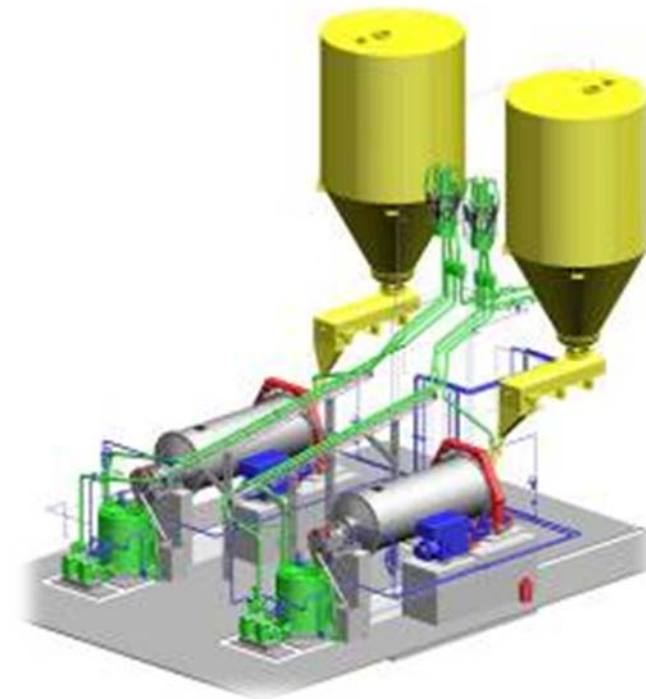

## Basic project data:

- **Year of Contract:** 2006  
**Year of Commissioning:** 2008 / 2009
- **Project Value:** 5,6 Mio EUR
- **Project Scope:**  
Engineering, equipment & steel structure supply,  
electric & control system, erection and  
commissioning
- **Equipment Basic Data:**  
2 x 21,8 tph limestone @ 90% < 44 µm  
2 x ball mill ø2,8 x 7,0 m; 710 kW installed, in closed  
circuit with hydrocyclone cluster 4+3

## 3D isometric view – 2 x 21,8 tph limestone grinding system

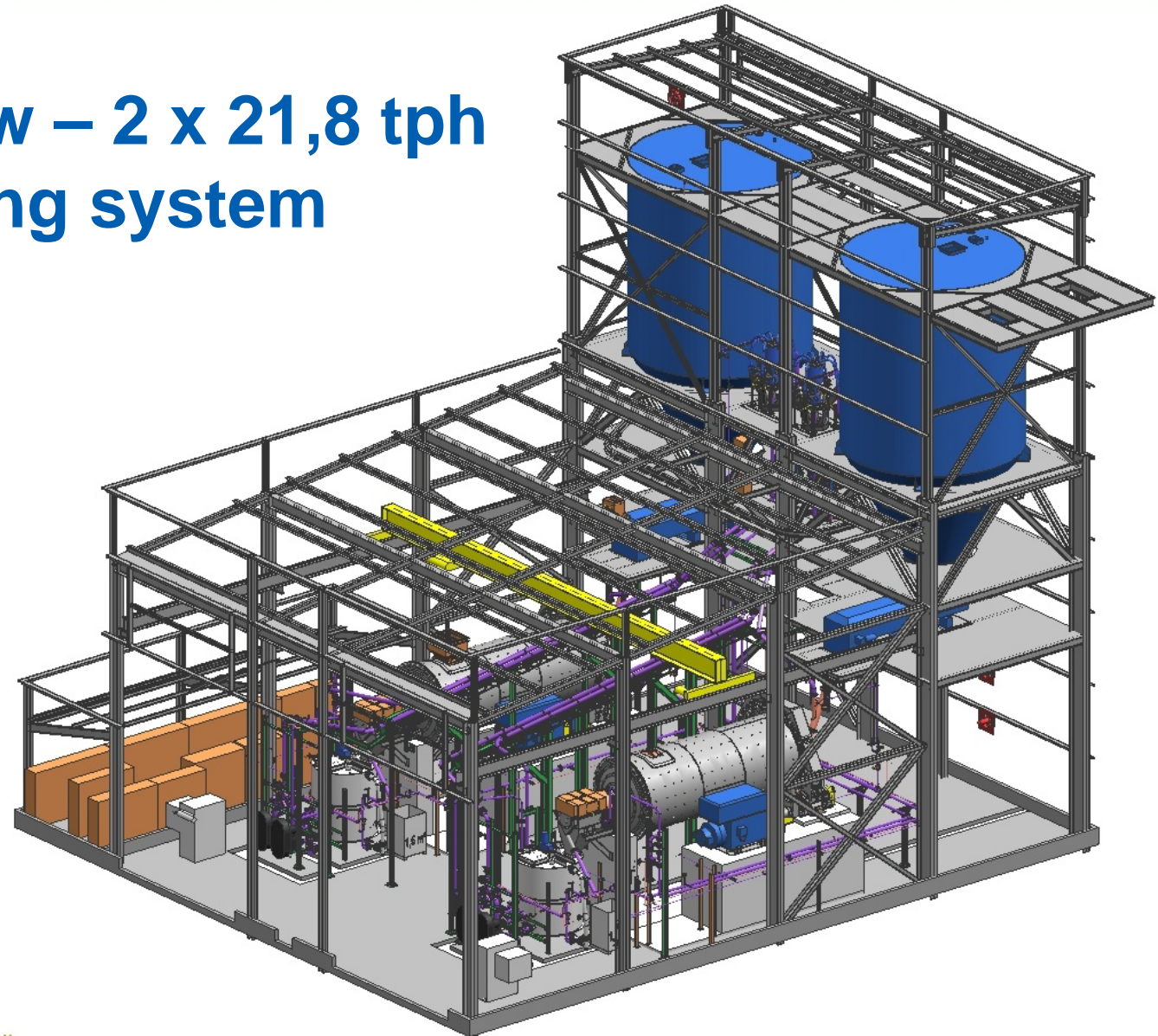

K

## ENEL POWER Puente Nuevo, Spain Limestone wet grinding plant 2 x 10 tph (FGD)



## Basic project data:

- **Year of Contract:** 2007  
**Year of Commissioning:** 2008/2009
- **Project Value:** 3,4 Mio EUR
- **Project Scope:**  
Engineering, equipment supply, electric & control system, erection and commissioning
- **Equipment Basic Data:**  
2 x 10 tph limestone @ 90% < 44 µm  
2 x ball mill ø2,4 x 5,5 m; 355 kW installed, in closed circuit with hydrocyclone cluster 2+3

## 3D isometric view – 2 x 10 tph limestone grinding system

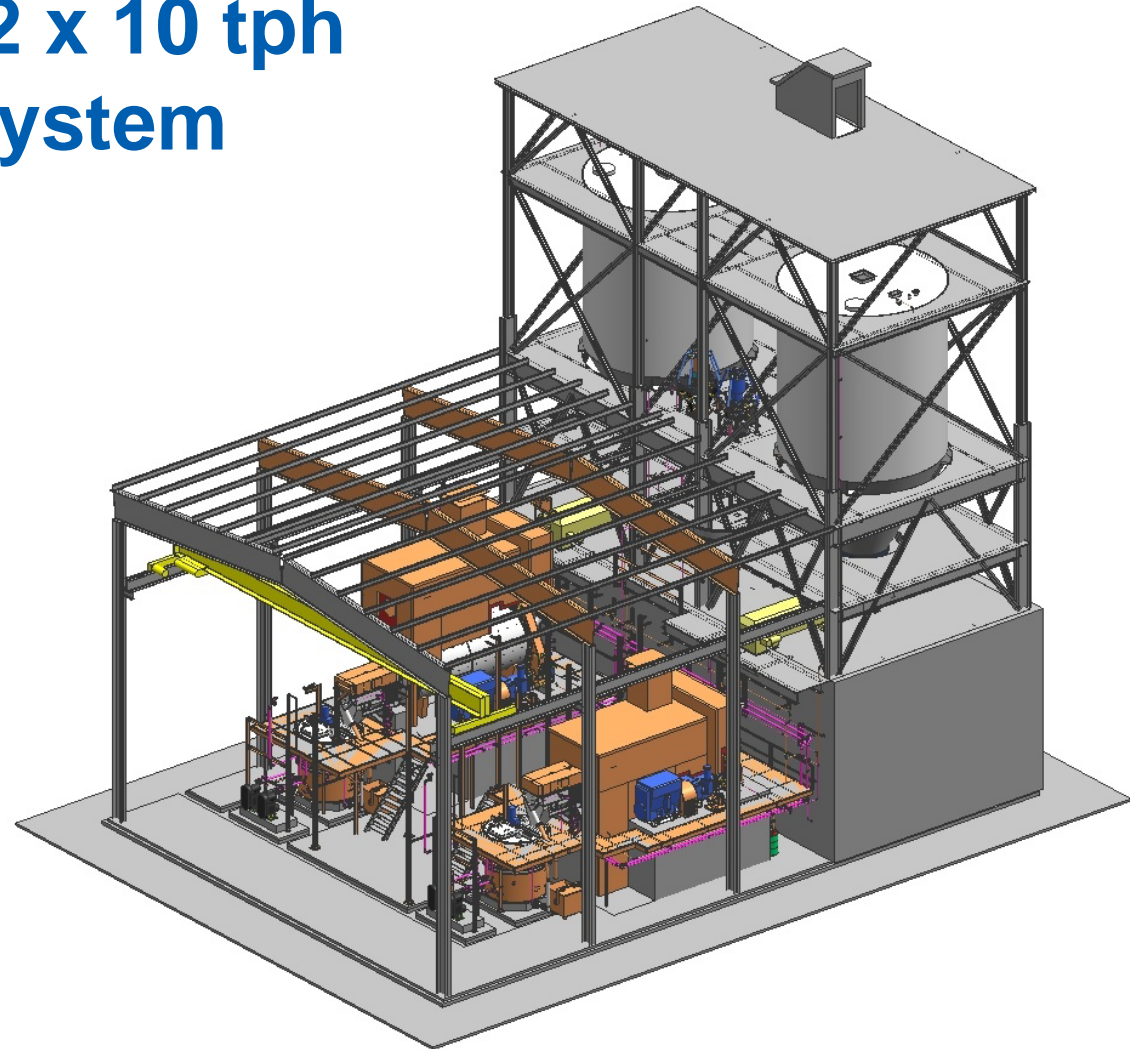

## OCP S.A. Khouribga, Morocco Phosphate wet grinding plant 4 x 120 tph





## Basic project data:

- **Year of Contract:** 2010  
**Year of Commissioning:** expected 2012
- **Project Value:** 6,72 Mio EUR
- **Project Scope:**  
Engineering, equipment supply, electric & control system, erection and commissioning supervision
- **Equipment Basic Data:**  
4 x 120 tph phosphate ore @ 80% < 140 µm  
4 x ball mill ø3,4 x 5,0 m; 1.000 kW installed, in closed circuit with hydrocyclones

## 3D isometric view – 4 x 120 tph phosphate grinding system

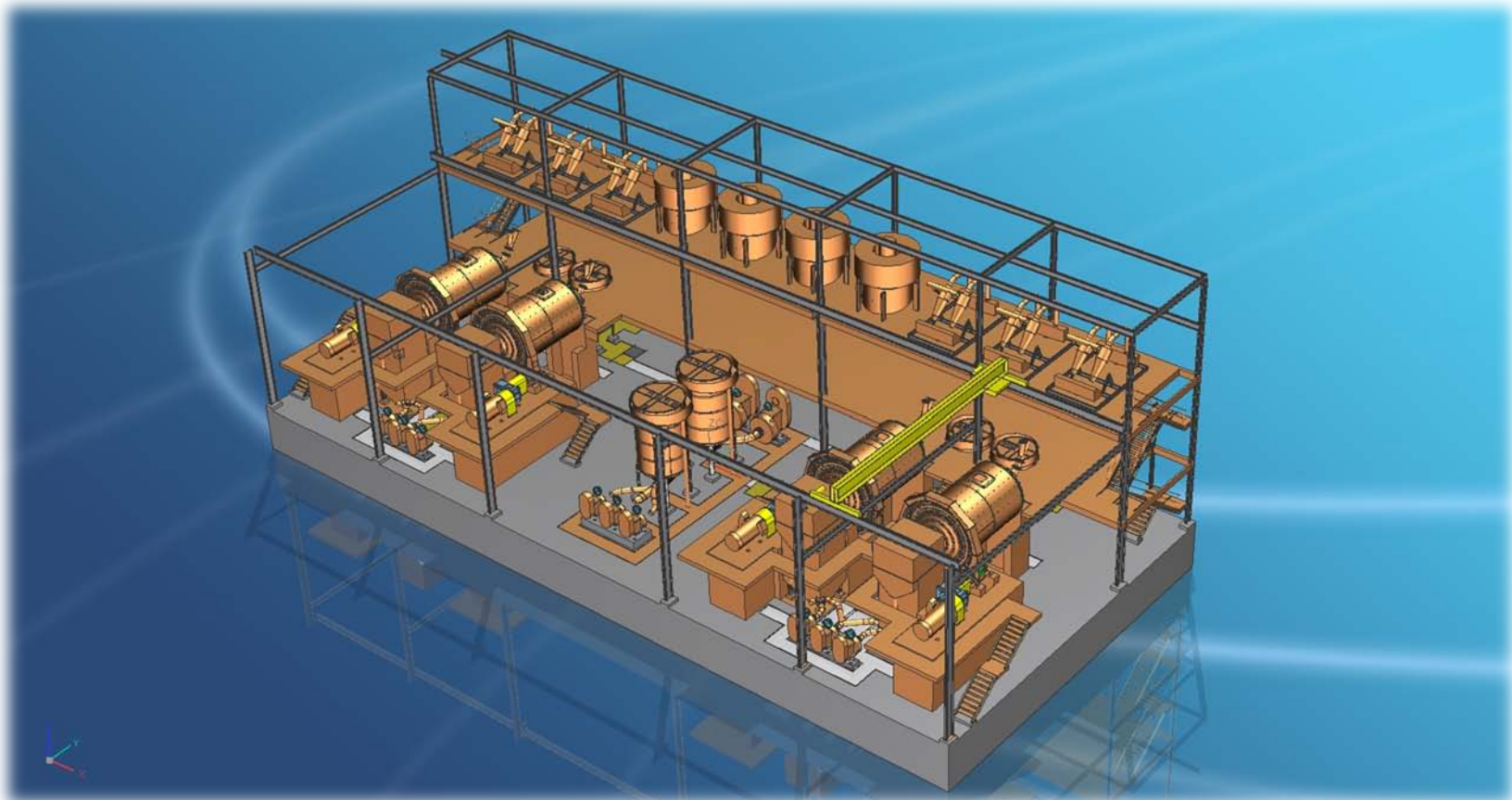

## **CURRENT PROJECTS (to be delivered in 2012/2013):**

### **Limestone grinding plant / BARRICK Gold / Argentina**

#### **- Equipment Basic Data:**

**2 x 180 tph limestone @ 80% < 117 µm**

**2 x ball mills à ø4,2 x 5,2 m ; 1.500 kW installed, in closed circuit with hydrocyclones**

**2 x 16 tph quick lime @ 80% < 75 µm**

**2 x ball mills à ø2,1 x 3,5 m ; 150 kW installed, in closed circuit with hydrocyclones**

## Limestone grinding plant (FGD) / KC Cottrell / Korea

### - Equipment Basic Data:

2 x 25 tph limestone @ 80% < 24 µm

2 x ball mills à ø3,0 x 6,5 m ; 740 kW installed, in closed circuit with hydrocyclones

## Limestone grinding plant (FGD) / KC Cottrell / Turkey

### - Equipment Basic Data:

2 x 14 tph limestone @ 80% < 32 µm

2 x ball mills à ø2,6 x 5,5 m ; 450 kW installed, in closed circuit with hydrocyclones